

# TRAFFIC DOORS

HIGH - QUALITY TRAFFIC DOORS



Integrity \* Innovation \* Energy Saving \* Competitive Pricing

We stand behind our products

Warranty: All TDK traffic doors have a standard 2 years warranty.

We design new specialty doors

Innovation: TDK engineering team continuously designs new traffic doors to better serve our customers' needs.

The most comprehensive range of traffic doors that can meet the needs of different customers with different application.



TDK Doors is a professional manufacturer of high-quality traffic doors. Our products are installed and performing well in a wide variety of applications and markets, including restaurants, grocery stores, refrigerated warehouses, food processing plants, and general industrial applications.

---

# PRODUCT SELECTION CHART

01

## HE 100

Application: Cooler need better insulation and energy saving

Technology: Double Gasketing and no thermal bridge

Patent Pending

02

## HE 50

Application: Cooler and heavy duty warehouse or high end supermarket store

Technology: No thermal bridge and reinforcement frame work inside

Patent Pending

03

## PL 300i

Application: Perfect for supermarket stores

Technology: Fast manufacturer and Fast delivery

04

## PL 24E

Application: Stores and restaurant

Technology: Fast manufacturer and Fast delivery

05

## RS 3000

Application: Store, restaurant and coffee shop

06

## Alu 1000/SS 1000

Application: Restaurant

## HE 100

Great R value with double gasket on the whole door make HE 100 perfect for cooler application

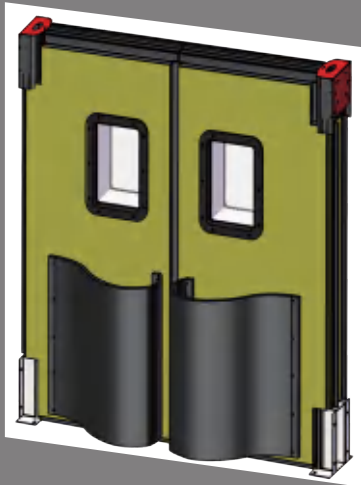

Fully sealed 4-inch thick insulated door panel, work with TDK heavy duty V-cam and rollers. Great R-value make HE 100 perfect for coolers.

Patent pending on double gasket design for all four sides of the door panel, this design will reduce end user's energy bill for sure.

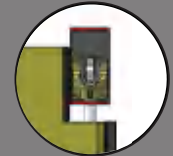

V-cam/Roller assembly hinge



4" door panel with double gasket patent pending



Royal Blue



Metallic Gray



Black



Cloud Gray



Beige



Red

### Door Panel

- 4" Thick Doors Panel with Tough Exterior
- Polyethylene Foam Core Chemically Bonded with ABS Finish
- Double Panes



### Options

- Window Sizes
- Bumper or Impact/Kick Plate
- Cart Guards
- Push Plate
- Pull Handle

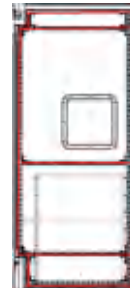

Reinforcement aluminum frame work inside of panel

### Applications

- Retail
- Restaurant
- Supermarket
- Food Service
- Institutional
- Industrial
- Warehouse

### Types of Traffic

- Personnel
- Cart
- Pallet Jack

### Environments

- Temperature - Cooler/Freezer
- Wash Down
- Corrosion Resistance

## HE 50

1 7/8" heavy duty panel make HE 50 withstand the most harsh application.



Fully sealed 1 7/8-inch thick insulated door panel, work with TDK heavy duty V-cam and rollers.

Many options on window and bumper size.

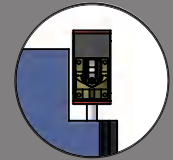

V-cam/Roller assembly hinge



Patent pending inside aluminum spine reinforcement with gasket



Royal Blue



Metallic Gray



Black



Cloud Gray



Beige



Red

### Door Panel

- 1 7/8" Thick Doors Panel with Tough Exterior
- Polyethylene Foam Core Chemically Bonded with ABS Finish



### Options

- Window Sizes
- Single Pane/Double Pane
- Bumper or Impact/Kick Plate
- Cart Guards
- Push Plate
- Pull Handle

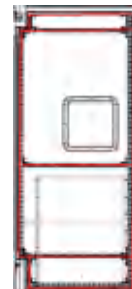

Reinforcement aluminum frame work inside of panel

### Applications

- Retail
- Restaurant
- Supermarket
- Food Service
- Institutional
- Industrial
- Warehouse

### Types of Traffic

- Personnel
- Cart
- Pallet Jack
- Motorized Forklift

### Environments

- Temperature - Cooler/Freezer
- Wash Down
- Corrosion Resistance

## PL 300i

This doors designed for strength and durability in tough applications.

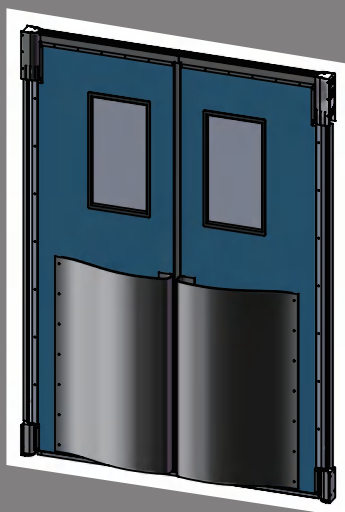

1 ½" insulated door panel, TDK heavy duty V-cam hinge, with reinforced spine, Insulated foam core chemically bonded with ABS finish.



V-cam/Roller assembly hinge



Aluminum extrusion back edge cap reinforcement



Royal Blue



Metallic Gray



Black



Cloud Gray



Beige



Red

### Door Panel

- 1 1/2" Thick Doors Panel with Tough Exterior
- Polyethylene Foam Core Chemically Bonded with ABS Finish



### Options

- Window Sizes
- Single Pane/Double Panes
- Bumper or Impact/Kick Plate
- Cart Guards
- Push Plate
- Pull Handle



### Applications

- Retail
- Restaurant
- Supermarket
- Food Service
- Cold Storage
- Institutional
- Industrial
- Warehouse

### Types of Traffic

- Personnel
- Cart
- Pallet Jack
- Motorized Pallet Jack

### Environments

- Temperature - Cooler
- Wash Down
- Corrosion Resistance

## PL 24E

This door is medium duty traffic door and designed to facilitate the flow of traffic in a variety of applications.



PL 24E is a medium duty traffic door and designed to facilitate the flow of traffic in a variety of applications.

With standard E hinge and different options on windows.

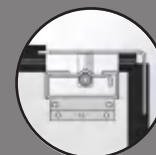

Classic E series gravity close hinge system



Aluminum extrusion back edge cap reinforcement



Royal Blue



Metallic Gray



Black



Cloud Gray



Beige



Red

### Door Panel

- .95 " Thick Doors Panel with Tough Exterior
- Plastic Honeycomb Core Chemically Bonded with ABS Finish



### Options

- Window Sizes
- Single Pane/Double Panes
- Bumper or Impact/Kick Plate
- Cart Guards
- Push Plate
- Pull Handle



### Applications

- Retail
- Restaurant
- Supermarket
- Food Service
- Institutional
- Industrial
- Warehouse

### Types of Traffic

- Personnel
- Cart
- Pallet Jack

### Environments

- Temperature - Ambient
- Wash Down



## RS 3000

Laminate finish with stainless steel edge cap give RS 3000 attractive good looking.

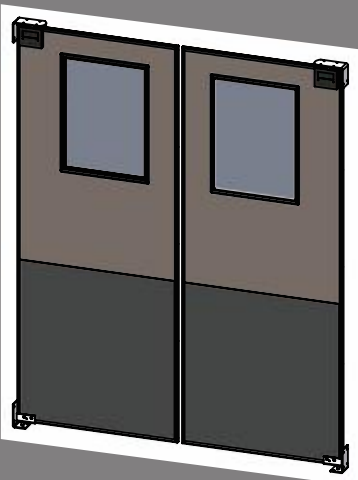

Variety of standard color choices.  
Single pane.(Window sizes optional).

Optional LLDPE tear drop spring bumpers.

Standard heavy-duty bottom hinge pin stabilizes the panel in the frame.



Classic E series gravity close hinge system

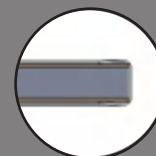

Stainless Steel Cap



special color available consult factory

## Door Panel

- 3/4" Thick Doors Panel with Tough Exterior
- Wood Core with Decorative Laminate

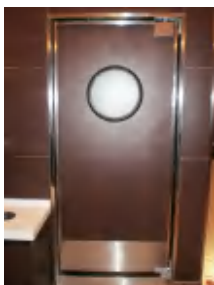
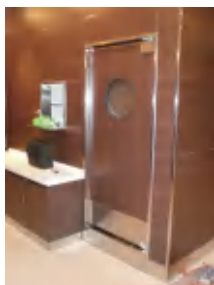

## Options

- Window Sizes
- Bumper or Impact/Kick Plate
- Cart Guards    • Push Plate    • Pull Handle



## Applications

- Retail
- Food Service
- Restaurant
- Supermarket

## Types of Traffic

- Personnel
- Cart

## Environments

- Temperature - Ambient



## Alu 1000 SS 1000

Aluminum/Stainless sheet doors is the most economy traffic door option in light duty application.



.06" Aluminum or stainless steel panel, with triangle aluminum extrusion edge, different window size is available.

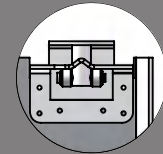

Sheet door E series hinge

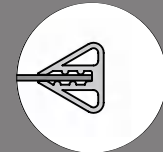

Triangle aluminum extrusion edge

## Door Panel

- Alu 1000 -- .06" anodized aluminum alloy door panel with aluminum triangle extrusion cap
- SS 1000 -- .06" Stainless steel sheet panel with aluminum triangle extrusion cap



## Options

- Window Sizes
- Bumper or Impact/Kick Plate
- Cart Guards



## Applications

- Retail
- Restaurant
- Institutional
- Food Service

## Types of Traffic

- Personnel
- Cart

## Environments

- Temperature - Ambient



**Minimum Panel Thickness: 1.1"**  
**1/8" Single Pane**

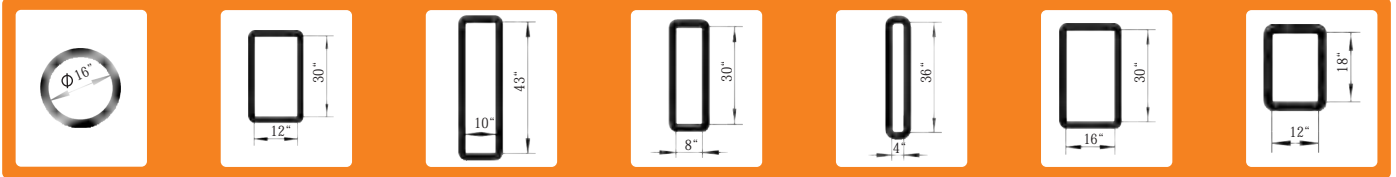

**Minimum Panel Thickness: 1.58"**  
**1/8" Single Pane**

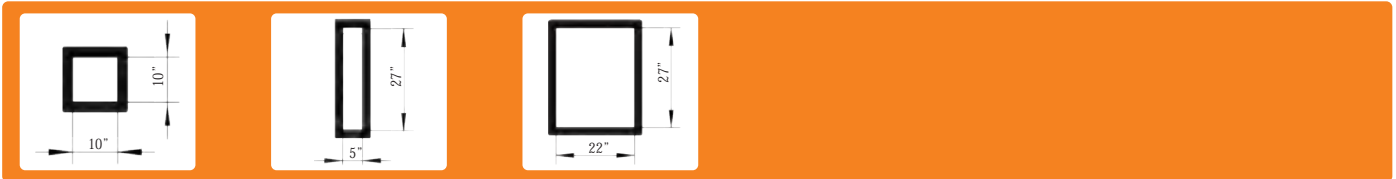

**Minimum Panel Thickness: 1"**  
**1/8" Single Pane**

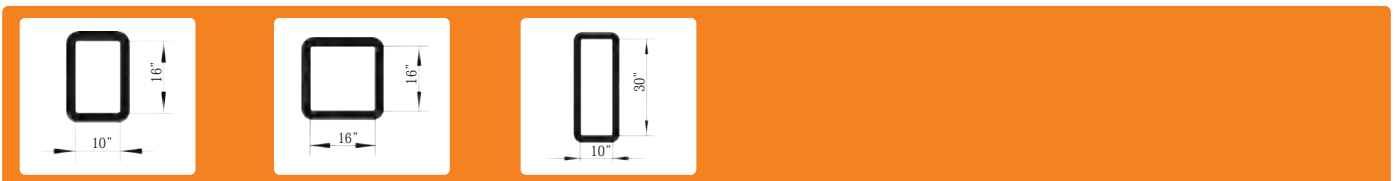

**Minimum Panel Thickness: 1.34"**  
**1/8" Single Pane**

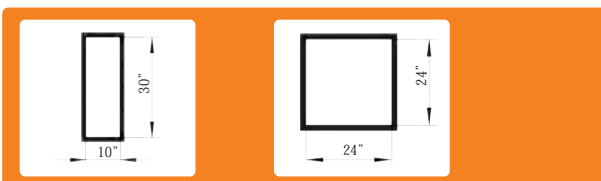

**Minimum Panel Thickness: 0.87"**  
**1/8" Single Pane**



## Traffic Door Hinges



## Traffic Door Gasket

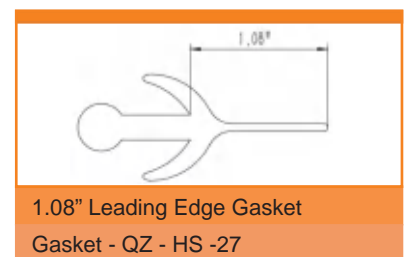
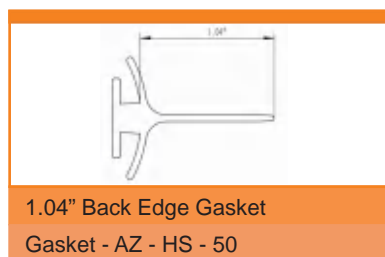
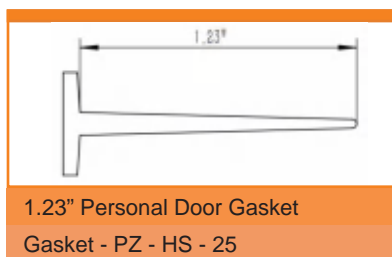
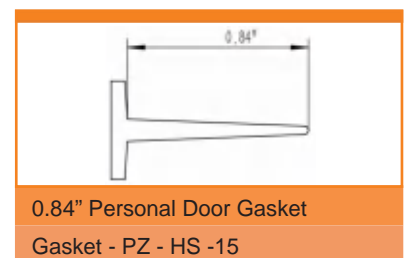
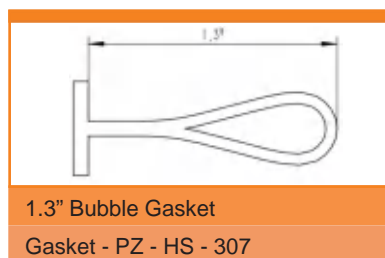
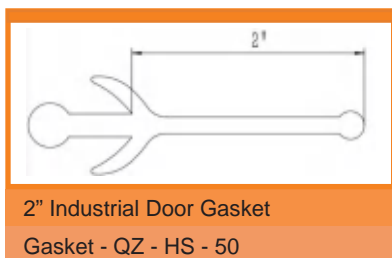

# MORE PRODUCTS >>>



Special Traffic Doors



High Speed Doors



Fiberglass Doors



Cold Storage Doors

## TDK Canada

TDK Doors Inc.

Address: 3211 152nd Street, Building 3211 C,  
Suite 402, Surrey, BC, V3Z 1H8

Tel: + 360 548 9123

